

THE DISTRICT — SHOPS



FIRST FLOOR RETAIL OPPORTUNITIES

RETAIL HIGHLIGHTS

- 1,302 SF In-Line Retail Available along City Center Drive
- Built-in Customer Base with Office and Residential Above
- High Traffic Draw with Pedestrian and Vehicle Access
- Dynamic cotenancy with MIKC, PureBarre, Savoy Tea, and more

LEASING CONTACT

ERIN JOHNSTON

P (816) 701-5028

ejohnston@copaken-brooks.com

DEVELOPMENT HIGHLIGHTS



When fully developed, City Center Lenexa will consist of more than 2 million square feet, including civic components for the City of Lenexa, nearly 1 million square feet of office and retail, and 375 residential units.

*Workday, weekend, all in one place.
the pulse of the city in the heart of the neighborhood*

Scan with your smartphone to view
Lenexa City Center Video



Work, play, live ...*all in one incomparable setting*

Welcome to The District,
the urban-suburban destination where retail,
corporate, residential, civic, and recreational
interests will come together to create an
experience unlike any other.

- 30,000 SF street-level retail and 175 residential units
- Total of 45,000 SF office space
- Walkable amenities ideal for daytime and night/weekend visitors
- Ample structured parking
- Signature office headquarters sites
- Prominent signage available
- Immediate access to Interstate 435

A day at the office, a night on the town, and *a place to call home*.

The District hosts a mix of living spaces allowing residents to take full advantage of their exciting new downtown surroundings.

A dynamic destination with an *entire community* around it.

Public amenities such as a multi-use civic center and on-site government blend with green spaces, parks, and community gathering areas.

With easy access to and from major roads and highways – 20 minutes from downtown Kansas City and 30 minutes from Kansas City International Airport – The District is truly a remarkable and exciting opportunity.



IN-LINE RETAIL

-
- A photograph of a modern multi-story building with a brick and glass facade. The ground floor features large glass windows and a covered entrance area. The upper floors have brick walls and balconies with black railings. A small tree is planted in a planter box on the sidewalk in front of the building. A street sign is visible on the left side of the image.

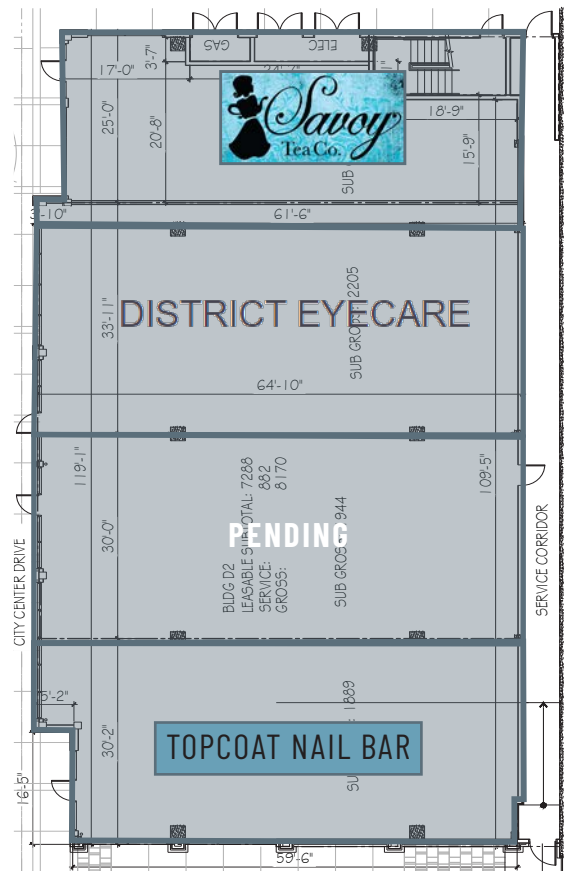

END CAP RETAIL



- Prime corner locations in the center of City Center Lenexa are Fully Leased
- Large outdoor patios
- High traffic draw with pedestrian and vehicle access
- Built-in customer base with office and residential tenants above

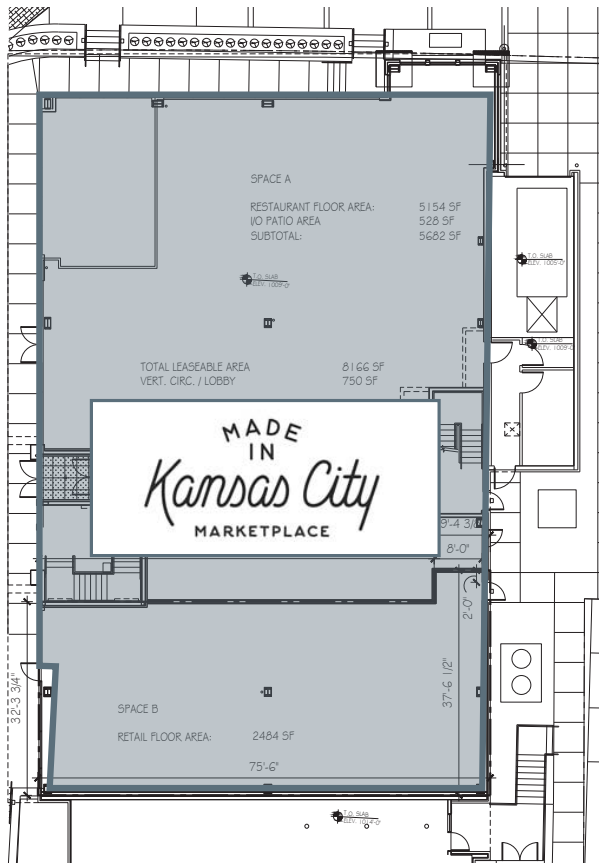

PENN I

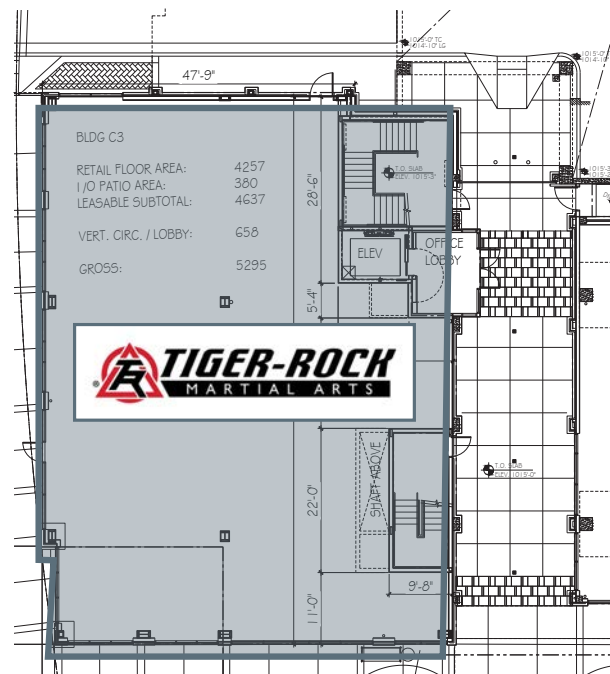

PENN II

CURRENT RETAIL

Office tenants have convenient front door access to the areas growing retail at the **District Shops**.



PENN III END-CAP



PENN II END-CAP



and much more in Lenexa City Center and surroundings.



CIVIC AND REC CENTER

A new city center is emerging as *a home* for civic activity and *a gathering place* for the community



kansascity.com



City Center Lenexa at City Center is envisioned as the new central meeting place for residents, as Lenexa's "new downtown" and gathering area

- 5 acre Civic Center site
- \$75 million investment
- City Hall
- Recreation facility
- Festival plaza and amphitheater
- Public Market
- Johnson County Library branch
- Shawnee Mission School District Aquatic Center
- Structured parking



LEGEND

- RETAIL / RESTAURANT
- RETAIL WITH OFFICE ABOVE
- RETAIL WITH PARKING ABOVE
- OFFICE
- RETAIL WITH RESIDENTIAL ABOVE
- RESIDENTIAL
- CIVIC
- FITNESS CENTER
- PARKING STRUCTURE
- KIEWIT BUILDINGS
- KIEWIT FUTURE EXPANSION

RETAIL OWNER AMENITIES

The amenity deck at Penn II is available to all retail tenants which includes:

Conference Room, Outdoor Deck with fireplace, Social lounge, and Full Kitchen



UNDER CONSTRUCTION AT CITY CENTER

AdventHealth purchased the land and is currently building a **27.5-acres Health and Wellness campus**.

The new development is situated at the Northwest Corner of 87th Street and Renner Boulevard, directly north of the Gateway Sites.

Construction is underway with hospital construction date expected for 2025.



“AdventHealth’s campus in Lenexa City Center will redefine health care in Kansas City.”

– Karsten Randolph, CFO of AdventHealth’s Mid-America Region



The new AdventHealth will include:

- A 100-bed hospital
- Medical office buildings
- Urgent care center
- Lifestyle center
- Retail & Commercial building



To learn more visit: www.adventhealth.com/hospital/adventhealth-lenexa

CURRENT PROGRESS



COMPLETED PROJECTS

Lifetime Fitness
Kiewit (Formerly Lexmark HQ)
Renner 89 Office & Retail
The Hampton Office & Retail
Domain Luxury Apartments
The District Flats

City Hall
Public Market
Johnson County Library Branch
Recreation Center
Shawnee Mission Aquatic Center



COMING SOON

"Main street" Office, Retail & Apartments on Penrose
AdventHealth Health and Wellness Campus
Restaurant Row
Gateway Development Sites
Park View North & South Development Sites

DEMOGRAPHICS

Located in Johnson County's ever-growing suburban community, City Center Lenexa will build on the energy of the entire city while creating a destination unto itself.

Ideally positioned at the intersection of I-435 and 87th Street, City Center Lenexa stands at the nexus of dramatic economic growth in western Johnson County. This progressive, technologically advanced area offers:

REGIONAL DRAW

- LifeTime Fitness (55,000 visits/month)
- Civic Center, City Hall, Aquatic Center, Library
- Shawnee Mission Park, 3&2 Baseball Park, Canyon Farms Golf Club

STRONG DEMOGRAPHICS

- 20% growth rate in the last ten years
- Residents: 48,000 (3 miles), 162,000 (5 miles)
- Average Household Income: \$102,000 (3 miles)

VIBRANT AREA

- 4 million SF of industrial space within 3 miles
- 2 million SF of office space on Renner corridor
- Daytime population 35,000+
- Over 4,000 apartments

Johnson County, Kansas is ranked in the nation's top 2% for income, is among the Midwest's top 10 counties for growth, and is home to some of the nation's top brands and Fortune 500 companies.

Largest employers in Lenexa



Lenexa, Kansas is home to more biotech companies than any other city in Kansas.



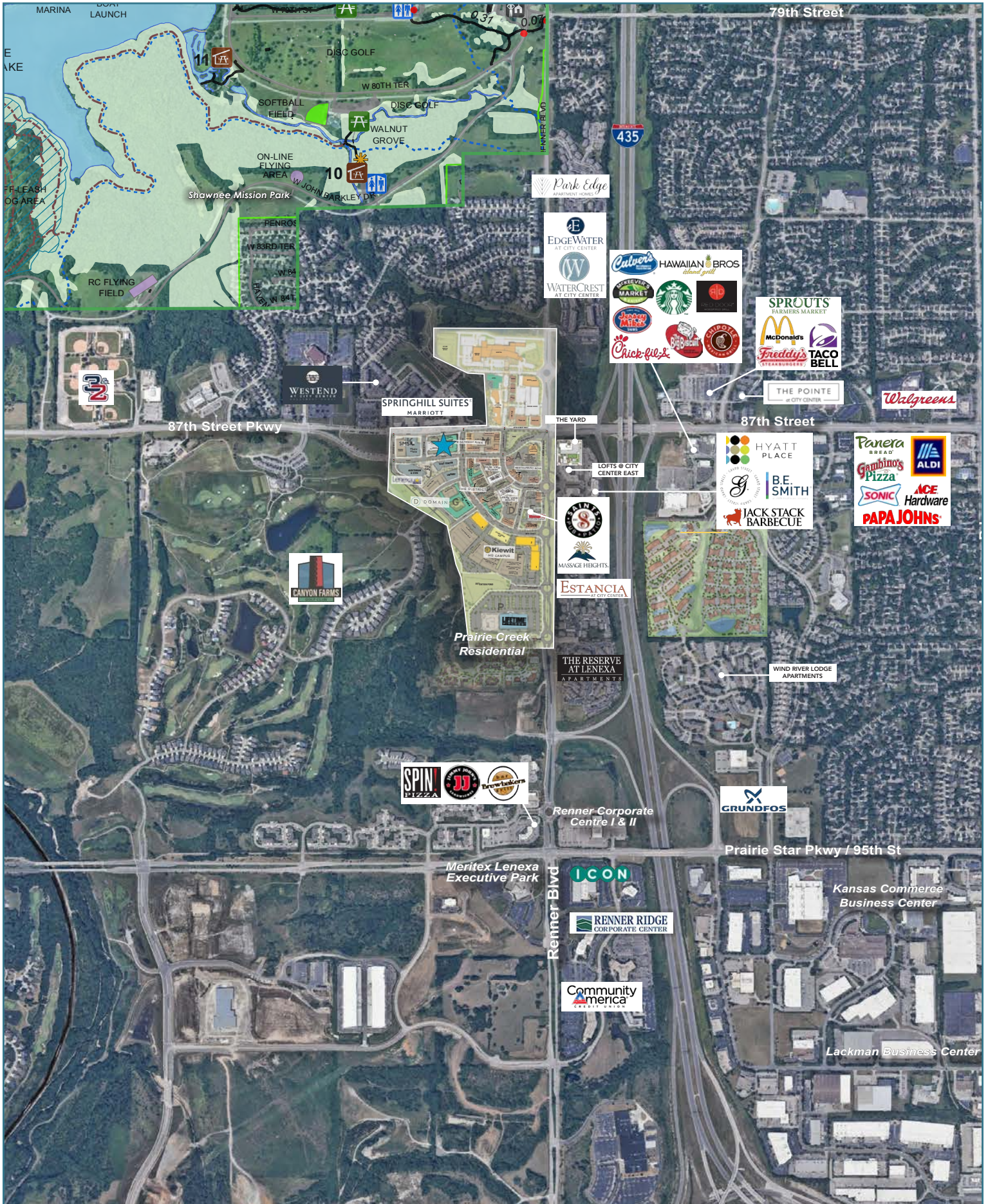

RETAIL SPACE AVAILABLE



LEASING CONTACT

ERIN JOHNSTON

P (816) 701-5028

ejohnston@copaken-brooks.com